

1.2 Dimensions

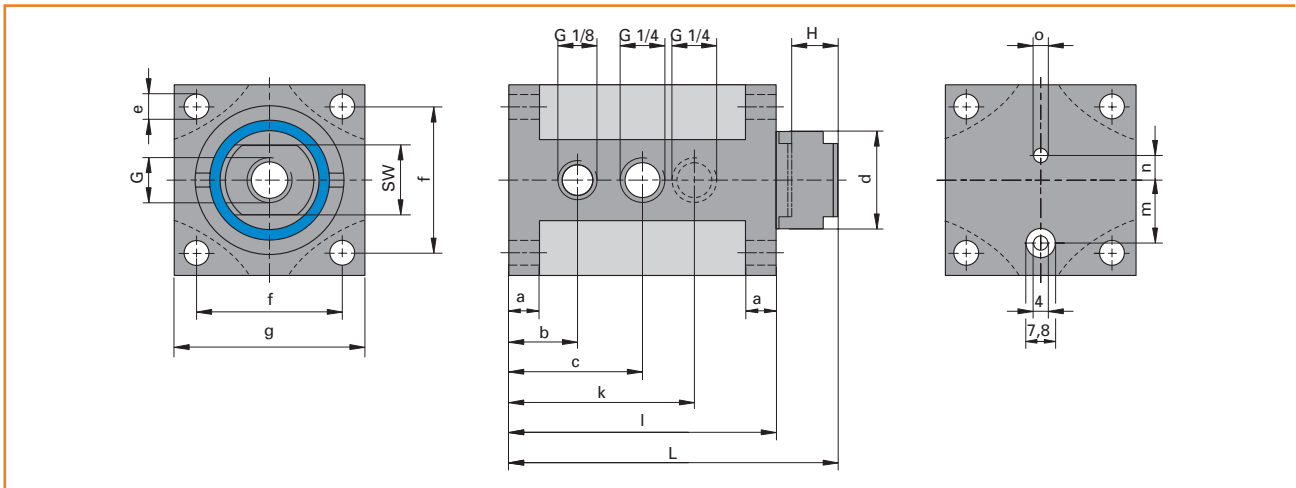

The dimensions in the table shown below apply to the universal version of the standard series of KOSTYRKA® hydraulic work supports.

Series		5310.10	5310.15	5310.20	5310.30	5310.40
		5312.10	5311.15	5311.20	5311.30	5311.40
		5312.15	5312.15	5312.20	5312.30	5312.40
Support pin diameter	d	10	15	20	30	40
Support pin stroke	H	10	12	15	16	20
Screw thread	G	–*	M 8	M 12	M 12	M 12
Spanner size	SW	–*	12	17	27	36
Overall length	L	71	86	97	112	134
Housing length	l	58	70	78	92	110
Width	g	45	50	55	65	80
Flange thickness	a	6	8	10	12	15
Distance between fixings	f	35	38	43	51	64
Fixing hole Ø	e	5,5	6,6	6,6	9	9
Height of ventilation connection	b	11	18	18	18	18
Height of hydraulic oil connection/ ventilation	c**	35,5	44	46	46	52
Height of hydraulic oil connection/ ventilation	k**	35,5	44	53	64	82
Series		5320.10	5320.15	5320.20	5320.30	5320.40
		5322.10	5321.15	5321.20	5321.30	5321.40
		5322.15	5322.15	5322.20	5322.30	5322.40
Air feed distance	n	–***	6	9	13	18
Hydraulic oil feed distance	m	15	19	21	26	32
Air feed Ø	o	–***	4	4	6	6

Subject to alteration

*) Omitted from the 5310.10 and 5320.10 series

The supporting pin here has a crowned supporting surface without a screw thread G or spanner faces SW.

**) Hydraulic oil connection or ventilation, depending on the fitting orientation. See section 1.4, "Venting after Assembly", in this connection.

***) Omitted from the 5320.10 and 5322.10 series For reasons of construction it is not possible to fit a ventilation connection in the foot flange. If the support pin is to be advanced by means of compressed air in this series, it can only be done by means of the side hole G1/8.